

### Caution

1. The product must be installed by professional technicians and power supply must be cut off before installation.
2. The diameter for AC input wire is 0.75mm<sup>2</sup> (complying with 60245 IEC57), which complies with the latest IEE electrical standards or national standards.
3. Do not touch the electronic circuit and its components.
4. Contact an authorised technical service centre for any repairs possibly required use only original spare parts.
5. Do not touch LED while installing or maintaining.
6. Sealing the entrance hole with glue after install is needed.
7. The light source contained in this luminaire shall only be replaced by the manufacturer or his service agent or a similar qualified person.

# A LED

## OPERATING MANUAL

### Pluto Sensor Photocell Advance CCT - Hvid - Microwave Sensor Dimming

Important: Please read the instruction manual carefully prior to installation and keep it for future reference.

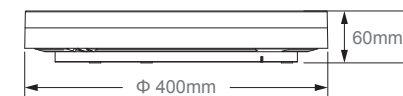

Order Code	Product Series	Power Adjustable	Function Description
Pluto Sensor Photocell Advance CCT-Hvid	Pluto	20/21/22/24/25/26/28/29/32W	Microwave sensor (Tri-level dimming, corridor function), Photocell Advance™

Mounting: Wall or Ceiling

Light features:

Ra: >80

Life Time: 5 years

Light Source: LED SMD2835

Input: 220V-240V 50/60Hz

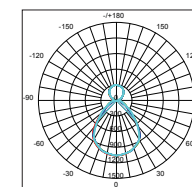

### Power Adjustable Options

Power	Current	1	2	3	4
20W	650mA	○	○	○	○
21W	700mA	○	○	○	●
22W	750mA	○	○	●	○
24W	800mA	○	○	●	●
25W	850mA	○	●	○	○
26W	900mA	○	●	○	●
28W	950mA	○	●	●	○
29W	1000mA	○	●	●	●
32W	1050mA	●	●	●	●



CCT



3000K  
4000K

### Accessories

No.	Pic	Qty.	Usage
1		3	Fix light
2		3	Rawl plug
3		3	Plastic washer
4		2	Cable clip
5		4	Fix cable clip

### Installation

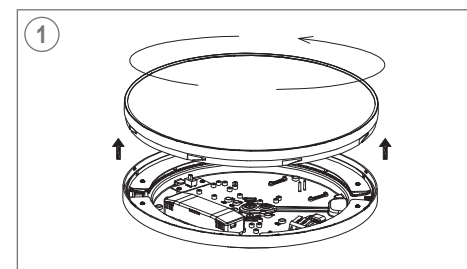

Twist the diffuser anticlockwise. Vertically remove the diffuser and PCBA.

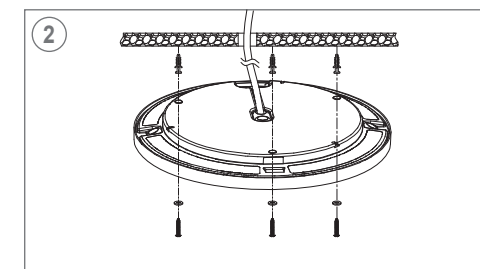

- a. Cut off the power. Thread the input cable through the rubber plug to the fixture. Connect the wire referring to the wiring diagram.
- b. Knock the rawl plugs into the pre-drilled holes on ceiling /wall. Wear plastic washers on self-tapping screws and tighten them to fix the fixture on ceiling/wall.



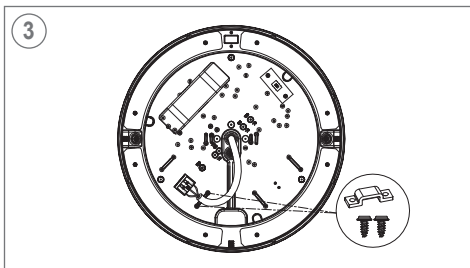

Install the cable clip.

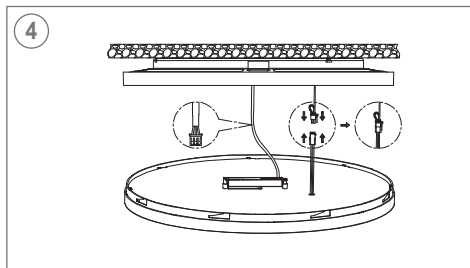

Connect the DC cable of PCBA and sensor.

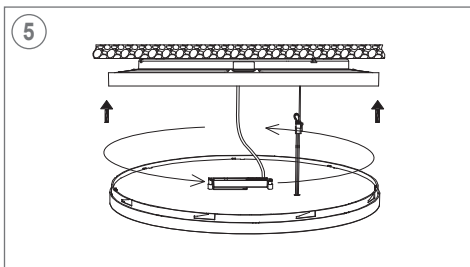

Mount the diffuser onto the base by twisting clockwise.

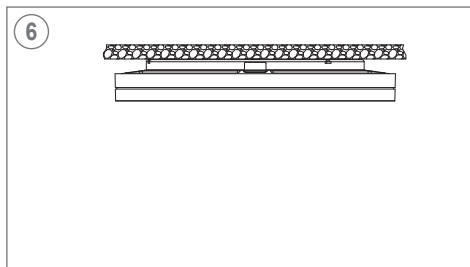

Installation finished.

## Wiring

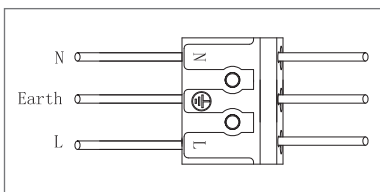

## Sensor Setting Options



### Sensitivity

Sensitivity can be adjusted by selecting the combination on the DIP switch for different applications.

	1	
I	●	100%
II	○	50%



I - 100%  
II - 50%



### Hold time

Hold-time refers to the time period that the light remains 100% on if no more movement is detected.

	2	3	
I	●	●	5s
II	●	○	90s
III	○	●	3min
IV	○	○	10min



I - 5s  
II - 90s  
III - 3min  
IV - 10min

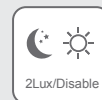

### Daylight sensor

Different daylight threshold can be preset on DIP switches. Light will always turn on upon movement if daylight sensor is disabled.

	4	5	
I	●	●	Disable
II	●	○	50Lux
III	○	●	10Lux
IV	○	○	2Lux



I - Disable  
II - 50Lux  
III - 10Lux  
IV - 2Lux

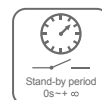

### Stand-by period (corridor function)

This is the time period that the light remains at a low level before it is completely turned off.

	6	7	
I	●	●	0s
II	●	○	10s
III	○	●	10min
IV	○	○	+∞



I - 0s  
II - 10s  
III - 10min  
IV - +∞

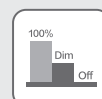

### Stand-by dimming level

Light can be dimmed to different levels after hold-time.

	8	
I	●	10%
II	○	30%



I - 10%  
II - 30%

## Detection Pattern

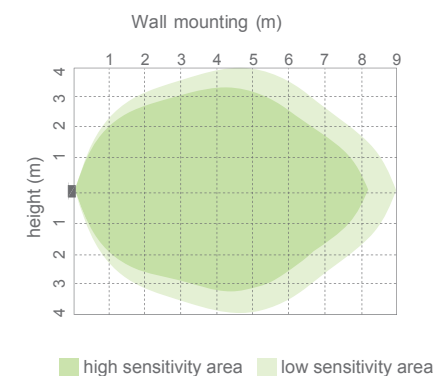
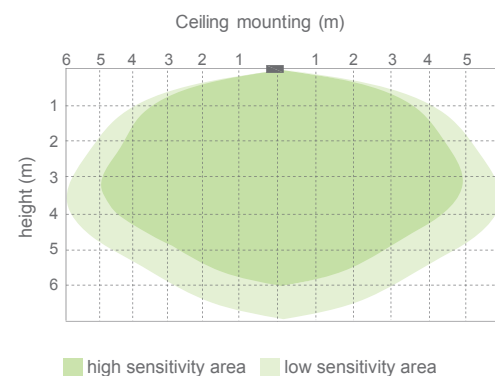

## Maintenance

1. Cut off the main power first.
2. Don't touch LEDs while maintaining or cleaning.
3. Don't use chemicals to clean the fixture.

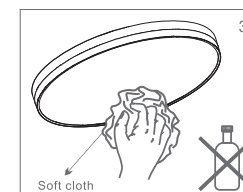
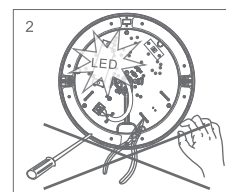
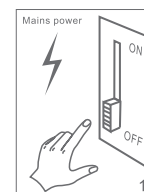

Environmental protection: waste electrical products should not be disposed of with household waste. Please recycle where facilities exist. Check with your local authority or retailer for recycling advice.

