

SIRIUS GEN2 EM MARINE GRADE

A
LED



Product data

General Information

EAN13 code	5710010140607
Light source type	LED
Number of LED module	1 unit
Energy class light source	Class D (A-G)
Color temperature	3000K or 4000K selectable
CRI	80
SDCM	3 steps
LED module replaceable	Yes, only by professionals
Number of LED driver	1 unit
Driver included	Yes
Driver replaceable	Yes, only by professionals
L90 lifetime of LED module	50,000 hrs
L80 lifetime of LED module	100,000 hrs
Lumen output	3600 lm / 3800 lm

Operating and Electrical

Input Voltage	220-240 Vac
Input frequency	50 / 60 Hz
System wattage	26 W
Power factor @ 230Vac	0.95
THD	< 10%
Surge protection	10 kV (L/N-Ground)
Inrush current	40A pk Max, th =200µs
Ambient temperature range	0°C to + 50°C
Performance ambient temperature Tq	+25°C

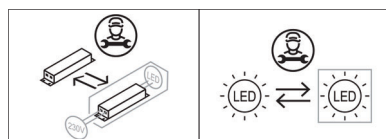

Installation method	Surface mounted
Optical type	Diffuser
Control and dimming	On/off
Connection type	6 pole connectors, 0.5...4mm ²
Protection class IEC	Safety class I
Through-wiring function	Yes, 2.5mm ²
Environment classification	CX (ISO 9223-2012)
Outdoor marine environment	Yes
Indoor marine environment	Yes
CE Mark	Yes
EU RoHS compliant	Yes

Emergency function

Emergency brightness	650 lm
Emergency power	4 W
Emergency duration	> 180 minutes
Batteries	LiFePO4
Emergency type	Standard

Mechanical and Housing

Housing material	Glass fiber reinforced PC
Optical material	Impact resistant PC
Cable entry	1 x M20L Gland
Blind caps	3 x M20L
Material of installation brackets	316L stainless steel
Ingress protection code	IP 66/67
Mech. impact protection code	IK 11 , 50J

Remarks

LED Driver failure rate at 50,000hrs	5 %
Power consumption tolerance	± 7 %
This item has internal battery for emergency	
Manual testing is needed according to European emergency light standards.	

Dimension drawings

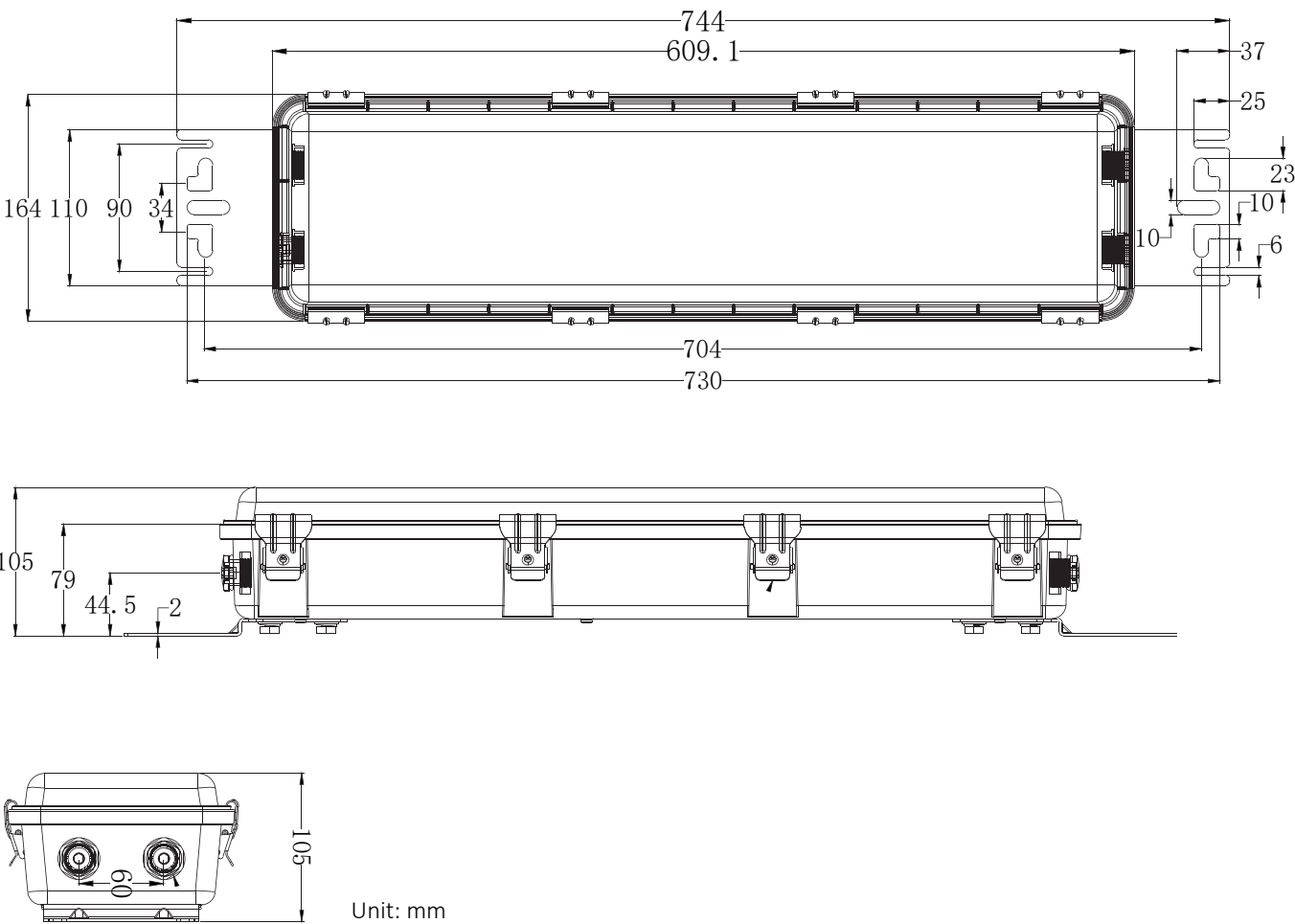

Max load on breaker

Type of electrical protection installation		Maximum number of luminaires to install
MCB16A	B TYPE	12
	C TYPE	20
Inrush Current (220VAC)		40A , 200µs

Installation

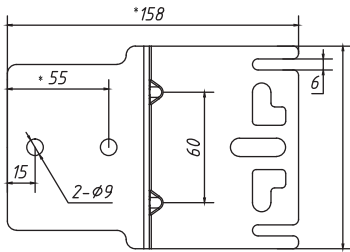
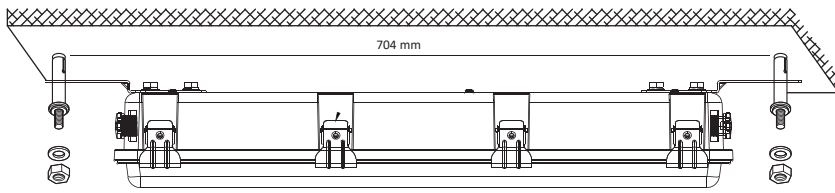

unit: mm

- Drill two holes in desired area and fix the luminaire firmly with M8 anchor bolts.

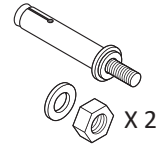
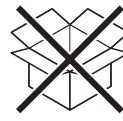

Anchor bolts not included !

Warning

Earthing the luminaire

The luminaire must be earthed in the terminal block. 

Power supply must be from same line (fuse).

Operation at temperatures outside of rated range will affect the battery life and/or the charging performance

It's very important that the luminaire is grounded. Failure to ground will create electrical shock hazards, which can cause serious injury and or death.

Technical information, advice and recommendations contained in these documents is based upon information that we believe to be reliable. All the information and advice contained in these documents is intended for use only by persons having been well trained and know-how to be used by such person only at their own risk and discretion. These instructions are informative only and does not cover all of the details, variations or combinations in which this product may be used, its storage, delivery, installation, check out, safe operation and maintenance. Since conditions of use of the product are outside of the care, custody and control of manufacturer, the purchaser should determine the suitability of the product for his intended use, and assumes all risk and liability whatsoever in connection therewith.

Wiring with 1-poled switch for main light

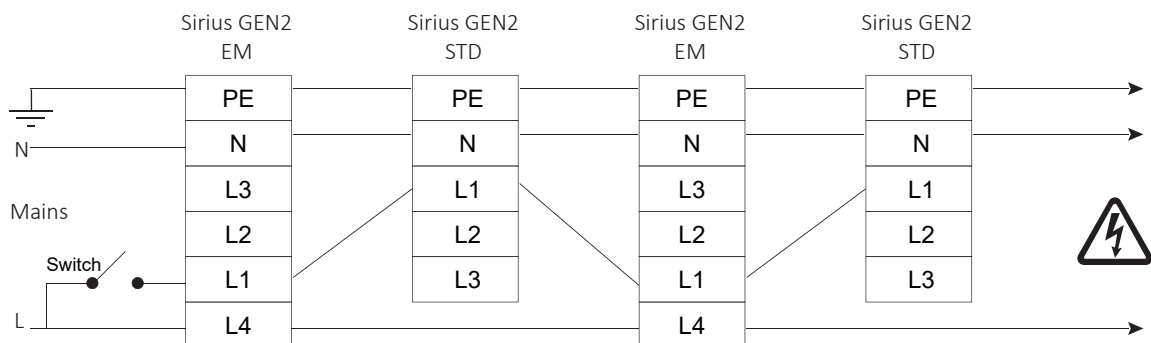

Condition	Sirius EM version	Sirius STD version	Sirius EM version	Sirius STD version
Switch on with power through L4	100% brightness/battery charging mode/green light	100% brightness	100% brightness/battery charging mode/green light	100% brightness
Switch off with power through L4	0% brightness/battery charging mode/green light	Light off	0% brightness/battery charging mode/green light	Light off
Power off	Emergency mode / 15% brightness / 3 hours duration	Light off	Emergency mode / 15% brightness / 3 hours duration	Light off

Wiring without switch for main light

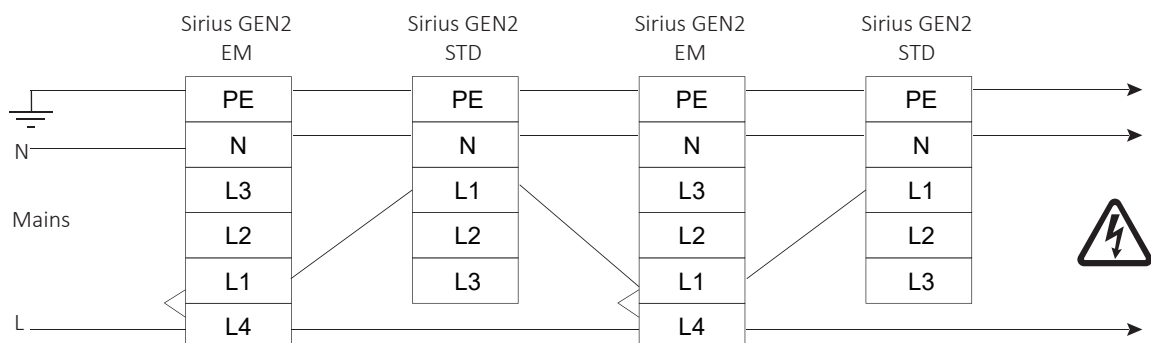

Condition	Sirius EM version	Sirius STD version	Sirius EM version	Sirius STD version
Power on	100% brightness/battery charging mode/green light	100% brightness	100% brightness/battery charging mode/green light	100% brightness
Power off	Emergency mode / 15% brightness / 3 hours duration	Light off	Emergency mode / 15% brightness / 3 hours duration	Light off